

gross floor area: 2698sq m / 29048sq ft  
net floor area: 2239.6sq m / 24107sq ft

02002-221/2  
FIRST FLOOR PLAN  
SCALE 1:200

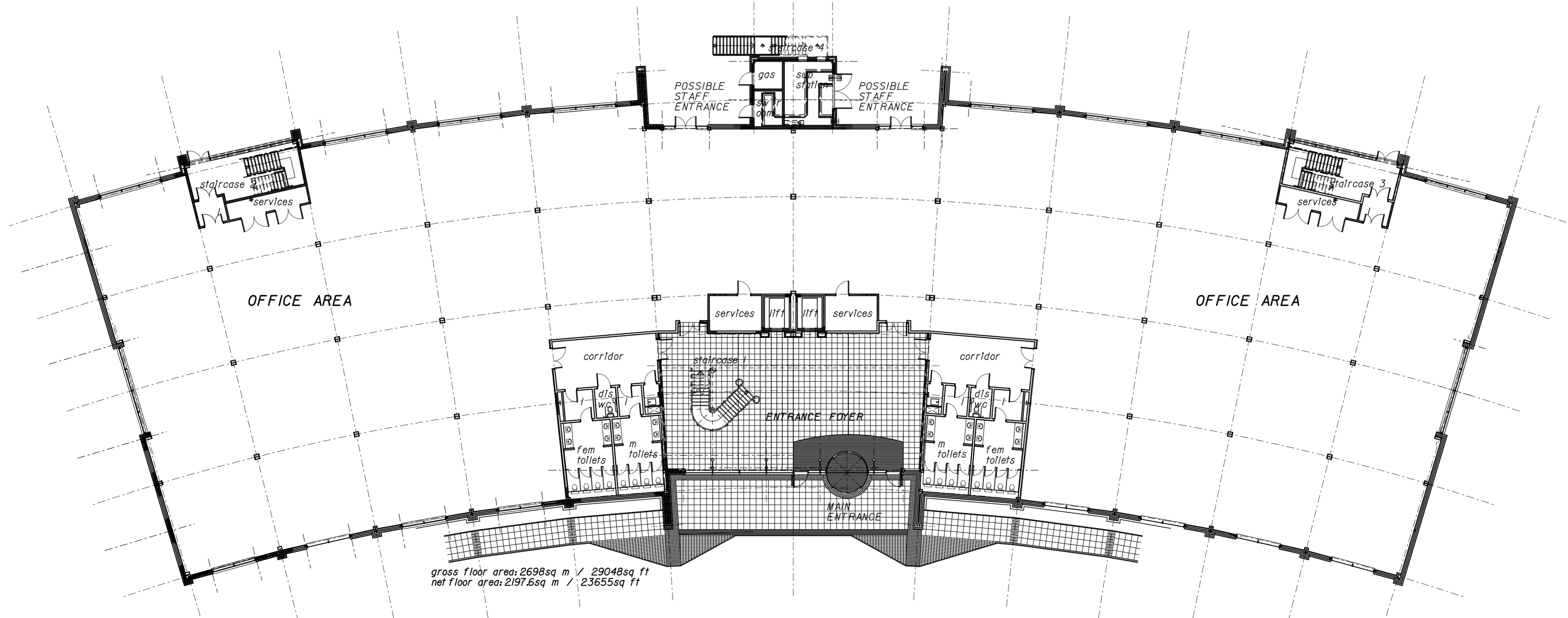

gross floor area: 2698sq m / 29048sq ft  
net floor area: 2197.6sq m / 23655sq ft

02002-221/1  
GROUND FLOOR PLAN  
SCALE 1:200

revision	description	date	by	checked
1	FIRST ISSUE	09/2/04	LGE	BF

For Explanation of Key See Issue Sheet

**red box design group**  
 Architecture Interiors Planning Project Management  
 St Nicholas Church, Newcastle upon Tyne, NE1 1RU  
 T: +44 (0)191 246 0505 F: +44(0)191 246 7111  
 E: mail@redboxdesign.com

project  
**BALLIOL QUORUM: Q4**

drawing  
**FLOOR PLANS**  
Ground and First Floors

scale	1:200	job no	02 002	diag no	
sheet	A1	status	RECORD	no	221
					R